

Type PC clock oscillator smd ceramic kovar package (1.0 ~ 200)MHz

- # excellent delivery for prototypes
- # standard and custom frequencies
- # (1.8, 2.5, 3.3 & 5.0)Vd.c. supply

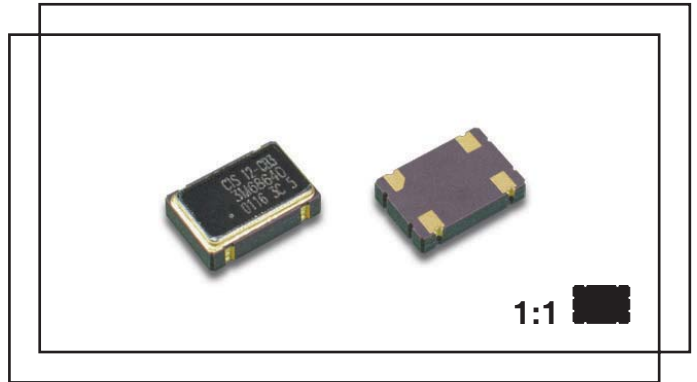

Electrical specification

Case style

Frequency range

Stability *

C: (7.0 x 5.0)mm, height 1.50mm

(1.0 ~ 200)MHz

±(20 ~ 100)ppm, temperature range dependent

Supply voltage V_{cc} ±10%

+1.8Vd.c.

+2.5Vd.c.

+3.3Vd.c.

+5.0Vd.c.

Maximum frequency within range

133MHz

166MHz

200MHz

133MHz

Supply current max.

10mA

15mA

20mA

45mA

Rise and fall time max. **

5ns

Operating temperature

(-20 +70)°C ~ (-40 +85)°C

Storage temperature

(-55 +125)°C

Output

HCMOS

Symmetry

(45 ~ 55)%, (40 ~ 60)%

Tri-state

tri-state output

Typical jitter

8ps RMS, 85pS pk-pk

* inclusive of calibration tolerance at +25°C, temperature tolerance, supply voltage variation, load variation, first year ageing, shock and vibration.

** measured, with an output load of 15pF, between (10 ~ 90)% V_{cc}

Ordering information

Example type PC oscillator, 72.00MHz,
+5.0Vd.c., tri-state, ±25ppm(-20 +70)°C,
CMOS 15pF, (45 ~ 55)%

TFC PART NUMBER PC 72.0M C P D C J

'PC' type number:

PC = smd clock oscillator type PC

'72.0M' frequency:

72.0M = 72.00MHz, from (1.0 ~ 200)MHz

'C' supply voltage:

C = +5.0Vd.c., E = +3.3Vd.c.,

J = +2.5Vd.c., K = +1.8Vd.c.

'P' tri state:

P = tri-state with programmed frequency

'D' frequency stability:

D = ±25ppm, G = ±50ppm, H = ±100ppm

'C' temperature range:

C = (-20 +70)°C, D = (-30 +80)°C,

L = (-40 +85)°C

'J' output logic and symmetry:

J = CMOS 15pF, (45 ~ 55)%,

K: CMOS 15pF(40 ~ 60)%

Dimensions(mm) shown twice full size

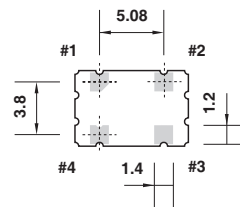
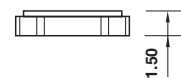
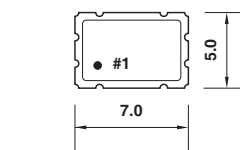

Pads viewed from bottom
#1 output inhibit (tri-state)
#2 ground
#3 output
#4 Vcc

Suggested land pattern

Connect 0.01µF capacitor
between Vcc and ground

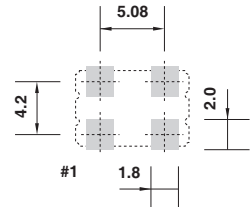

Output inhibit:

#1 high: output oscillation
#1 low: output high impedance